



**Winnow™**  
24" x 28" wall cabinet  
**K-33583-ASB**

**Features**

- Open shelf offers easy access to storage, while interior shelf provides ample space for extra toilet paper
- Three-way adjustable slow-close door hinges for easy cabinet access
- Finish-matched 10"-deep cabinet interior
- Customize your storage with optional accessories such as floor liners, drawer organizers, and perfectly sized containers (sold separately)
- Coordinates with K-33584 upgraded hardware finishes (sold separately)

**Material**

- Solid wood and moisture-resistant MDF
- Painted exterior

**Installation**

- Easy installation – no special tools required

**Included Components**

Additional Components:

Wall-mounting hardware



**Codes/Standards**

EPA TSCA Title VI/CARB P2



**KOHLER® One-Year Limited  
Warranty**

See website for detailed warranty information.

**Available Colors/Finishes**

*Color tiles intended for reference only.*

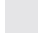
**Color Code Description**

	0	White
	1WX	Grey Slate

# KOHLER®

**Winnow™**  
24" x 28" wall cabinet  
**K-33583-ASB**

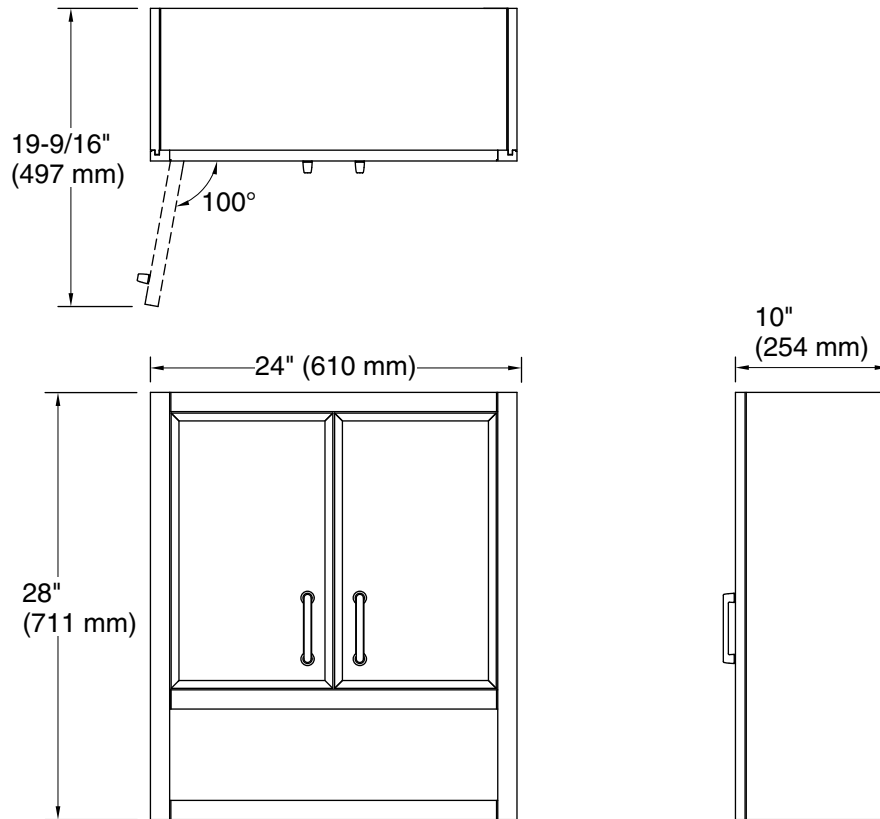

## Technical Information

All product dimensions are nominal.

## Notes

Install this product according to the installation instructions.

1-800-4KOHLER (1-800-456-4537)

Kohler Co. reserves the right to make revisions without notice to product specifications.

For the most current Specification Sheet, go to [www.kohler.com](http://www.kohler.com).

4-11-2023 23:10 - US/CA/LM/MX

THE BOLD LOOK  
OF **KOHLER®**